

oriordanbond
FOR SALE
01604 880077

Woodsfild

Brixworth, Northamptonshire

oriordanbond
SALES & LETTINGS



Woodsfield

Brixworth

NN6 9DP

PRICE £320,000

A superb brand new end of terrace property, situated on the very edge of the desirable village of Brixworth, with outstanding views across rolling countryside. The property benefits solar panels and under floor heating to the ground floor accommodation.

Entrance hall, sitting room with dual aspect and built-in under stairs storage cupboard. kitchen/dining room with French doors to the garden and integrated appliances to include, oven, hob, fridge/freezer and slimline dishwasher, a rear hall giving access to utility room and cloakroom/WC. To the first floor are two double bedrooms, an office/box room and a bathroom. Outside to the front is a garden laid to lawn with double width block paved drive providing off road parking for two cars. There is a fully enclosed wrap around garden with raised patio off the kitchen/diner enjoying the superb field views. (A/750/S)

Additional information

- Council Tax Band: New Build
- Energy Efficiency Rating: A

Viewing

Viewing strictly by appointment – details below

Disclaimer

O'Riordan Bond Estate Agents Limited has not tested apparatus, equipment, fittings or services and so cannot verify they are in working order. The buyer is advised to obtain verification from their solicitor or surveyor.

O'Riordan Bond Brixworth Sales

01604 880077

brixworth@oriordanbond.co.uk

GROUND FLOOR

1ST FLOOR

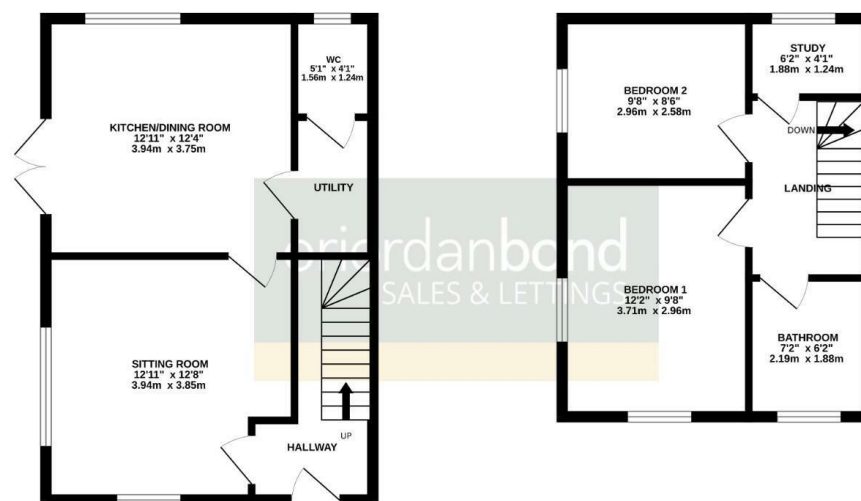

TOTAL FLOOR AREA : 751 sq.ft. (69.8 sq.m.) approx.

Whilst every attempt has been made to ensure the accuracy of the floorplan contained here, measurements of doors, windows, rooms and any other items are approximate and no responsibility is taken for any error, omission or mis-statement. This plan is for illustrative purposes only and should be used as such by any prospective purchaser. The services, systems and appliances shown have not been tested and no guarantee as to their operability or efficiency can be given.
Made with Metropix C5024

